

# Mobile Start/Stop Check-In



Note: Only individuals who have been granted administrative access in KidCheck (as an Administrator, Campus Manager, or Start/Stop Admin) can start or stop check-in.

## To Start Mobile Check-in Station:

- 1) Open the KidCheck App on the mobile device
- 2) Sign into KidCheck with your username and password
- 3) Select on the **Check-in** tab
- 4) Choose **Use as Check-in Station**
- 5) Choose either Check-In **Templates/Program** and select the corresponding template/program
- 6) On the **Select Printer** screen, select on your PrintHub Express and select the appropriate printer for your check-in.

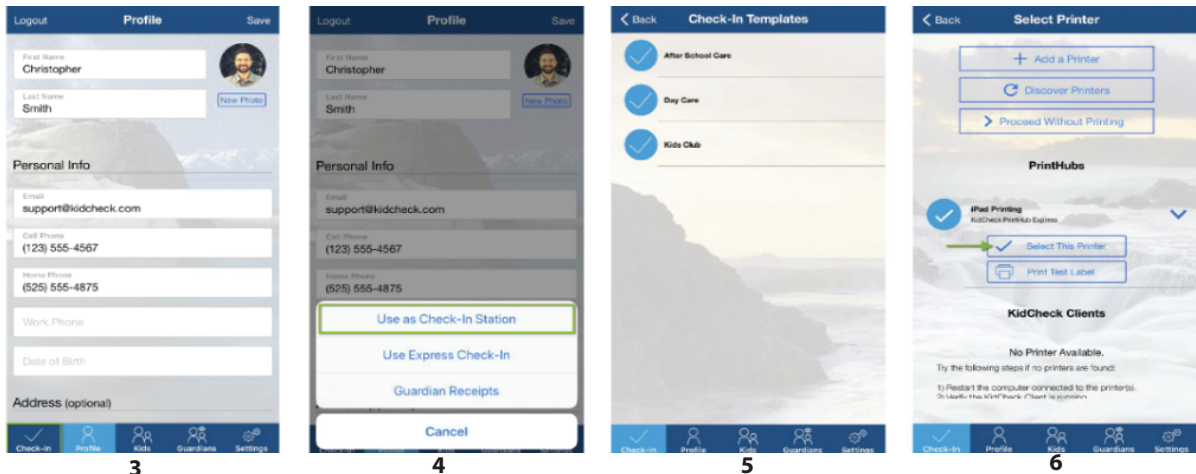

## To Stop Check-in Station:

### iPad Station:

- 1) Double click the **home-button** of the iPad and to show your most recently used apps
- 2) Swipe **left** or **right** until you see the KidCheck App
- 3) Swipe **up** on the App's Preview page to close the KidCheck App

### Android Station:

- 1) Launch the recent applications menu by double clicking the home-button of the Android tablet.
- 2) Find the KidCheck Application and swipe to the **right** or **left**.

**Note:** Force closing an application on Android Tablet will be different depending on the model of the device.